

Guide cylinder DFM-N-20-30-B-P-A-GF

Part number: 570565

FESTO

The proximity switch, type SMTSO-8E, can be used with this product with stroke lengths of 20 to 40 mm only when the corresponding mounting kit, type SMB-8E, is mounted outwardly.

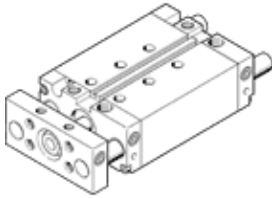

Data sheet

Feature	values
Stroke	30 mm
Piston diameter	20 mm
Operating mode of drive unit	Yoke
Cushioning	P: Flexible cushioning rings/plates at both ends
Assembly position	Any
Guide	Plain-bearing guide
Design structure	Guide
Position detection	For proximity sensor
Working pressure	2 ... 10 bar
Mode of operation	double-acting
Operating medium	Compressed air in accordance with ISO8573-1:2010 [7:4:4]
Note on operating and pilot medium	Lubricated operation possible (subsequently required for further operation)
Corrosion resistance classification CRC	2
Ambient temperature	-20 ... 80 °C
Theoretical force at 6 bar, return stroke	141 N
Theoretical force at 6 bar, advance stroke	188 N
alternative connections	See product drawing
Pneumatic connection	M5
Materials note	Conforms to RoHS
Materials information for cover	Wrought Aluminum alloy
Materials information for seals	NBR
Materials information, housing	Wrought Aluminum alloy
Materials information for piston rod	High alloy steel, non-corrosive